

15L ASH VACUUM

3500060 - Instruction Manual

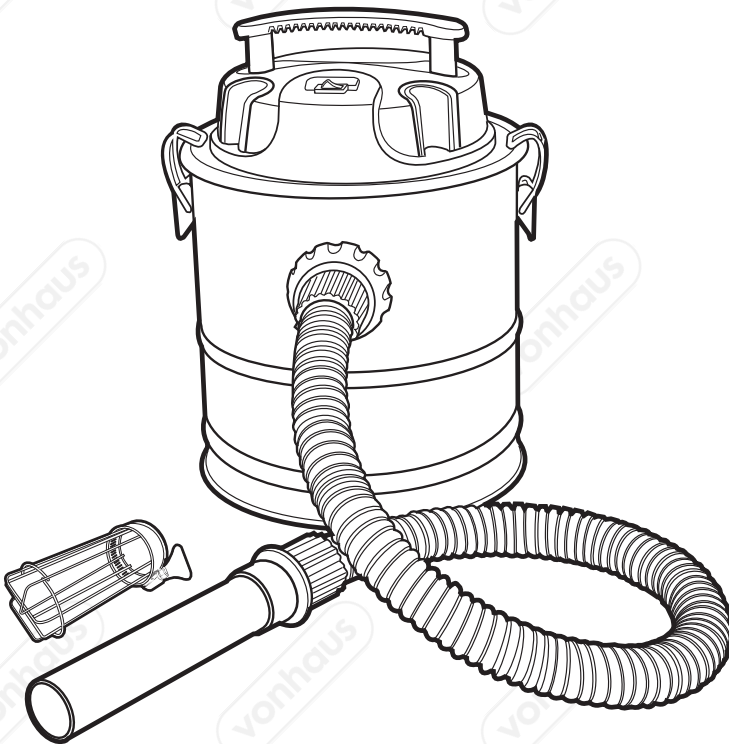

CONTENTS

Safety Instructions

1

Specification

2

Usage, Removing the Filters

3

Cleaning the Filters

4

Troubleshooting

5

Warranty

6

Vonhaus

Vonhaus

Vonhaus

Vonhaus

Vonhaus

Vonhaus

Vonhaus

Vonhaus

Vonhaus

Vonhaus

Vonhaus

Vonhaus

Vonhaus

Vonhaus

Vonhaus

Vonhaus

⚠️ WARNING ⚠️

PLEASE READ THESE INSTRUCTIONS CAREFULLY AND KEEP FOR FUTURE REFERENCE INTENDED USE.

The VonHaus Ash Vacuum is intended for domestic use only. It is not intended for use in commercial or industrial environments and is not suitable for use outdoors or on wet surfaces.

This appliance is not intended for use by persons (including children) with reduced physical, sensory or mental capabilities, or lack of experience and knowledge, unless they have been given supervision or instruction concerning the use of the appliance by a person responsible for their safety.

GENERAL PRECAUTIONS.

Do not allow to be used as a toy. Close attention is necessary when used near children.

If the appliance is not functioning properly, has been dropped, damaged, left outdoors or immersed in liquid, do not use, contact DOMU Brands Customer Services.

Do not use the appliance if any parts appear to be faulty, missing or damaged.

Ensure all parts are securely attached before using the appliance.

CABLES AND PLUGS.

Check to ensure your electricity supply matches that shown on the rating plate. The appliance must only be used as rated.

The use of an extension cable is not recommended.

Do not handle the plug or the appliance with wet hands.

Keep the cord away from heated surfaces.

Do not pull the cable around sharp edges or corners.

Do not run the Ash Vacuum over the cord.

Do not unplug by pulling on the cable. To unplug, grasp the plug, not the cable.

Do not use with a damaged cable or plug. If the supply cable is damaged, it must be replaced by a qualified engineer or authorised service agent in order to avoid a hazard.

RISK OF PERSONAL INJURY.

Never use the Ash Vacuum without both the Fabric Filter and HEPA Filter correctly and securely in place.

Do not use any filter other than those supplied with the Ash Vacuum.

Do not use the appliance in areas where flammable or combustible liquids may be present.

When using this appliance for the first time, a smell or vapour may be given off. This will dissipate after a few uses.

Only use the Ash Vacuum to vacuum the following substances:

- Ashes from admissible fuels
- Cold ashes from fireplaces, wood/coal stoves, ashtrays or grills

NOTE: The term "cold ash" refers to ash that has been left to cool down for a sufficient time and is free of any embers. This can be confirmed by scouring the ash for

pockets of embers using metal tools before using the Ash Vacuum. Cold ash does not emit any recognisable heat.

In order to prevent damage to the product and reduce risk of fire and/or personal injury, the following objects are strictly prohibited from being sucked up:

- Anything that is burning or smoking such as cigarettes, matches or hot ashes
- Any hot, burning or glowing objects
- Any objects that are hotter than 40°C
- Ashes or other objects within the fire that are not completely extinguished
- Soot
- Reactive liquids (solvent, corrosive, detergent).
- Flammable or explosive substances such as alcohol, thinners etc.
- Large or broken objects such as glass

WARNING! Do not use for the separation of health-hazardous dusts (dust classes M).

Keep hair, loose clothing, fingers and all parts of the body away from openings and moving parts.

Do not insert any objects into openings or cover the appliance.

Do not leave the appliance unattended when plugged in. Unplug from the outlet when not in use, and before performing user maintenance, connecting or disconnecting attachments or changing accessories.

Use only as described in this manual and with DOMU Brands recommended attachments only.

CLEANING, STORAGE AND MAINTENANCE.

Empty and clean the Ash Vacuum before and after use to avoid the collection of materials that could pose a fire hazard.

In order to maintain performance, it is essential that the Ash Vacuum is cleaned regularly and that any blockages are prevented or cleared immediately.

Store the appliance indoors in a cool, dry place.

Do not carry out any maintenance or repair work other than that shown in this manual, or as advised by the DOMU Brands Customer Care Helpline.

Use only the accessories and spare parts supplied by, or authorised by, DOMU Brands.

THERMAL CUT-OUT.

This appliance is fitted with a safety thermal cut-out which will switch off the Ash Vacuum automatically should it overheat.

The Ash Vacuum may overheat if the Filters are clogged, the Flexible Hose is blocked or the tank is full.

Empty the tank, remove any blockages and/or clean the Filter before next use.

The Ash Vacuum will become operational again after allowing **30-60 minutes** to cool down.

SPECIFICATION

VOLTAGE	FREQUENCY	POWER	CAPACITY	FILTER TYPE
V	Hz	W	L	
220-240	50/60	800	15	HEPA

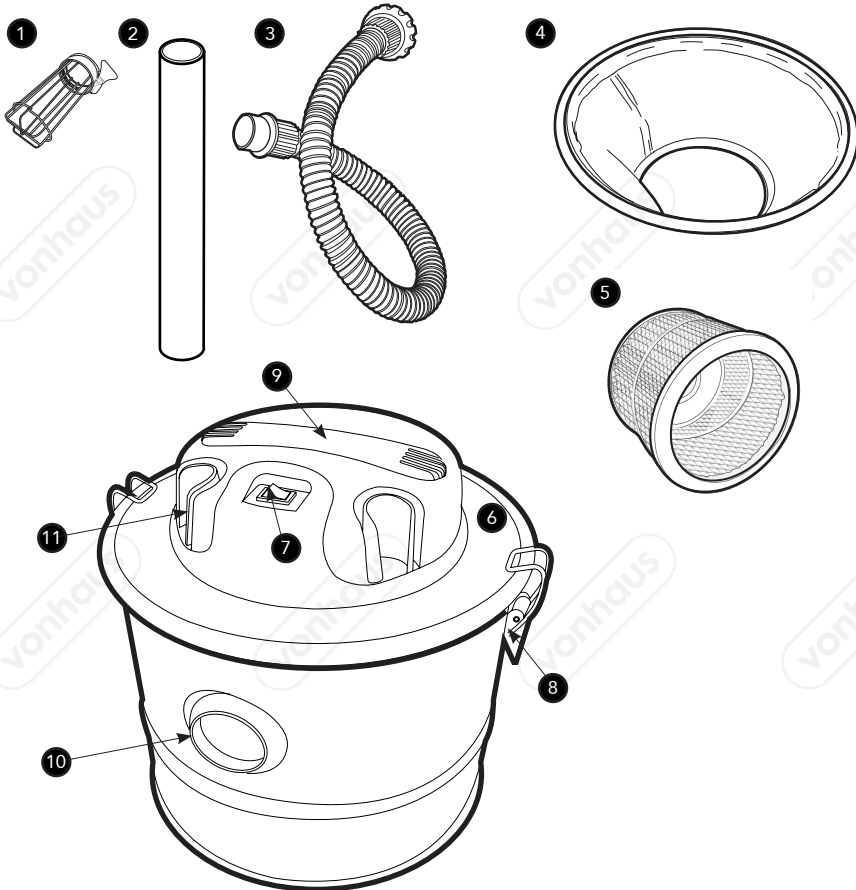

1. Debris Filter.

2. Metal Tube

3. Flexible Hose

4. Fabric Filter

5. HEPA Filter

6. Main Unit

7. ON/OFF Switch

8. Release Clips

9. Handle

10. Vacuum Inlet

11. Attachment Storage

USAGE

To assemble the Ash Vacuum, insert the screw end of the Flexible Hose (3) into the Vacuum Inlet (10). To insert, align the notches and twist to secure into position Fig 1.

NOTE: If the area you are to vacuum contains large pieces of debris it is advised you attach the Debris Filter (1) to avoid clogging up the Vacuum.

To use the Debris Filter, loosen the screw and slide the Debris Filter over the Metal Tube (2), re-tighten screw to secure into place. Fig 2.

NOTE: Leave a small distance between the end of the Debris Filter and Metal Tube.

To power on the Ash Vacuum, press the ON/OFF Switch (7) located on the top of the Main Unit (6). To power off, press the ON/OFF Switch to the off position.

CAUTION: Always ensure that both the Fabric Filter (4) and the HEPA Filter (5) are in place before operating the Ash Vacuum.

WARNING! Never vacuum hot embers. Always ensure that the ashes have been left too cool for approximately **four days**. Always use metal fireplace tools to sift the ash to check for embers.

CAUTION: Ensure the outside of the Flexible Hose does not come into contact with any hot surfaces. Although the centre is lined with a metal lining, the outer is plastic and this could cause damage.

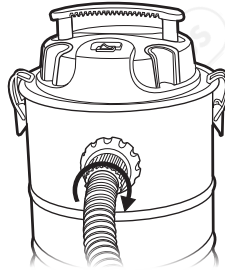

Fig 1.

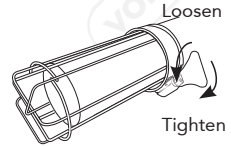
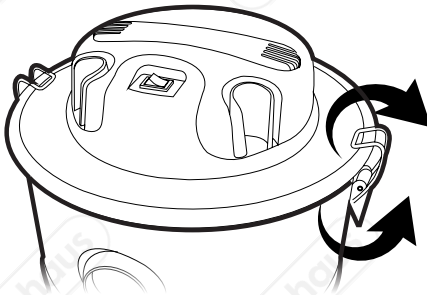

Fig 2.



REMOVING THE FILTERS

The Ash Vacuum has 2 filters: a Fabric Filter (4) located inside the Main Unit, and a HEPA Filter (5) attached to the lid of the Main Unit.



To access the Filters, remove the lid by unclipping both Release Clips (8) located on the sides of the Main Unit (6). To release the catch, lift up the handle on the bottom of the Release Clips.

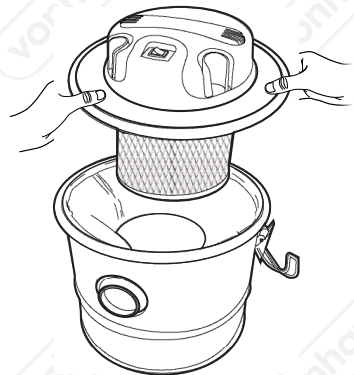

IMPORTANT: We recommend that the Fabric Filter and HEPA Filter are removed and washed every **2-3 uses**.

CLEANING THE FILTERS

Simply lift out the Fabric Filter (4) and clean using warm water and mild detergent.

IMPORTANT: Always allow the Fabric Filter to air-dry completely before returning to the Ash Vacuum.

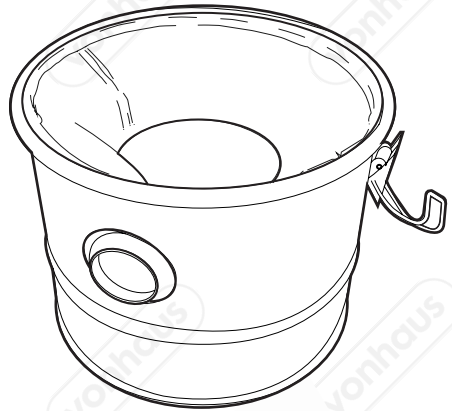

To remove the HEPA Filter (5), twist and lift to remove from the top of the Ash Vacuum.

Clean the HEPA Filter from the inside outwards; this will ensure the removal of debris and ash.

Ensure the HEPA Filter has air-dried completely before replacing.

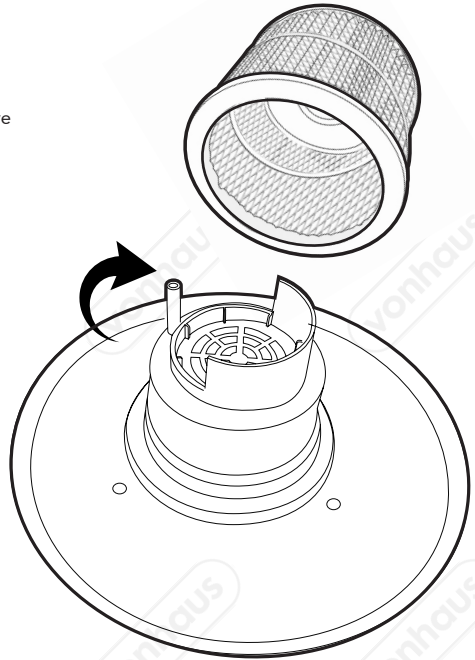

TROUBLESHOOTING

CAUTION: Before attempting troubleshooting, power off the appliance and disconnect from the plug socket.

PROBLEM	SOLUTION
VACUUM WILL NOT START.	<p>Remove the plug from the mains and reinsert.</p> <p>Check that all components are securely connected.</p> <p>Check that the HEPA Filter is securely in place. Ensure that it is pressed against the small white button and that it is fully pressed inwards.</p>
LOSS OF SUCTION.	<p>Check the Flexible Hose, Metal Tube, Debris Attachment, Fabric and HEPA Filters and openings for any obstructions and remove.</p> <p>Remove and empty the Fabric Filter.</p> <p>Clean the Fabric and HEPA Filter (see the 'Cleaning the Filters' section on the previous page).</p> <p>Check that all components are securely connected.</p> <p>Ensure the Debris Attachment is fitted before cleaning up large clumps of debris. This should prevent any possible blockages from happening.</p>
VACUUM CUTS OUT.	<p>Thermal cut-out has activated. Empty the tank, remove any blockages and/or clean the Filters. The appliance will become operational again after allowing 30-60 minutes for it to cool down.</p>

If you are having difficulty using your product and require support, please contact hello@DOMU.co.uk

DISPOSAL INFORMATION

Please recycle where facilities exist. Check with your local authority for recycling advice.

WARRANTY

To register your product and find out if you qualify for a free extended warranty, go to:

www.VonHaus.com/warranty

Please retain a proof of purchase receipt or statement as proof of the purchase date.

The warranty only applies if the product is used solely in the manner indicated in the Warnings page of this manual, and all other instructions have been followed accurately. Any abuse of the product or the manner in which it is used will invalidate the warranty.

Returned goods will not be accepted unless re-packaged in its original packaging and accompanied by a relevant and completed returns form. This does not affect your statutory rights.

No rights are given under this warranty to a person acquiring the appliance second-hand or for commercial or communal use.

COPYRIGHT

All material in this instruction manual are copyrighted by DOMU Brands Ltd.

Any unauthorised use may violate worldwide copyright, trademark, and other laws.

VonHaus.com

Thank you for purchasing the 15L Ash Vacuum.

VonHaus® is a registered trademark of DOMU Brands Ltd
Made in China for DOMU Brands Ltd M24 2RW.

VonHaus®